

Horizontal Cartridge Dust Collectors (AS Type)

General Features

- ▲ Modular design and assembly
- ▲ Compact footprint and structure
- ▲ Built-in fans, pulse valve, controller, pressure gauge
- ▲ Available with various types of filter media to suit application
- ▲ Filter cartridges accessible from the outside for fast changeout

Standard Operating Conditions

- ▲ Ambient Temperature: 5°C to 50°C
 - ▲ Lower temperatures up to -20°C
- ▲ Wind loading rating: up to 160 km/hr
- ▲ Housing rating (kPa): +3.8/-5.0

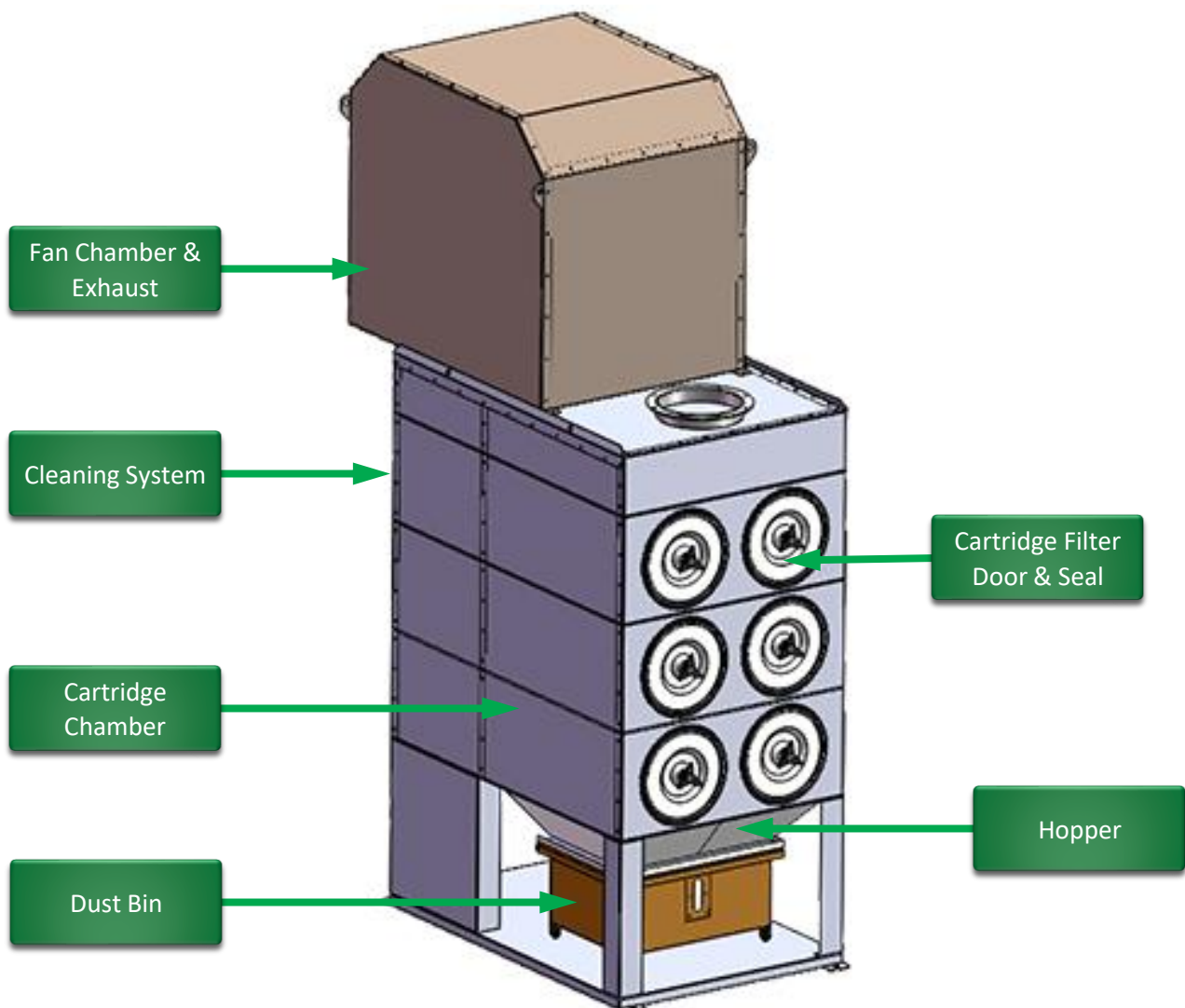

BASIC TECHNICAL SPECIFICATIONS

Model		APC-AS2-1000	APC-AS2-2000	APC-AS4-3000	APC-AS4-4000	APC-AS6-5000	APC-AS8-7000	APC-AS8-9000
Material / Finish		Steel / Powder Coated (APCINFRA Standard Colour: SILVER)						
Total Airflow (m ³ /h)		1600	2400	3200	4800	5400	7200	9600
# Filter Cartridges		2	2	4	4	6	8	8
Total Filter Area (m ²) (SBP / Cellulose)		30 / 64	30 / 64	60 / 128	60 / 128	90 / 192	120 / 256	120 / 256
Centrifugal Fan Motor (3Ph / 415V / 50Hz)		3.0kW	4.0kW	5.5kW	7.5kW	11kW	11kW	15kW
Dimensions (mm)	Length	1496	1496	1496	1496	1496	1496	1496
	Width	1114	1114	1114	1114	1114	1114	1114
	Height	1594	1594	2060	2060	2526	2526	2992
Compressed Air Requirement (MPa)		0.62-0.67 or (90-100 psig)						
Standard Components		<ul style="list-style-type: none"> ▲ Cartridge filter chamber ▲ Clean air chamber ▲ Fan, Fan chamber & Fan control cabinet ▲ Polyester cartridge filters ▲ Hopper 		<ul style="list-style-type: none"> ▲ Supporting legs ▲ Dust bin ▲ Pulse valves (1" Diaphragm Valve incl. Solenoid Valve, 24VDC) ▲ Compressed air tank 		<ul style="list-style-type: none"> ▲ Pulse valve controller (Timer Board, 24VDC) ▲ Differential pressure gauge ▲ Powder coating finish (silver) 		
Optional Components		<ul style="list-style-type: none"> ▲ Various media cartridge filter ▲ Spun Bond Polyester ▲ Cellulose ▲ Antistatic ▲ With PTFE Membrane 		<ul style="list-style-type: none"> ▲ Fan acoustic chamber ▲ Explosion vent and/or spark arrestor ▲ Differential pressure controller ▲ Epoxy top coating 		<ul style="list-style-type: none"> ▲ Pulse on demand controller ▲ Skid mount base ▲ Arctic enclosures for extreme temperatures ▲ Variable speed drives ▲ Built-in air compressor 		

Typical Mounting Details – Fan on Top

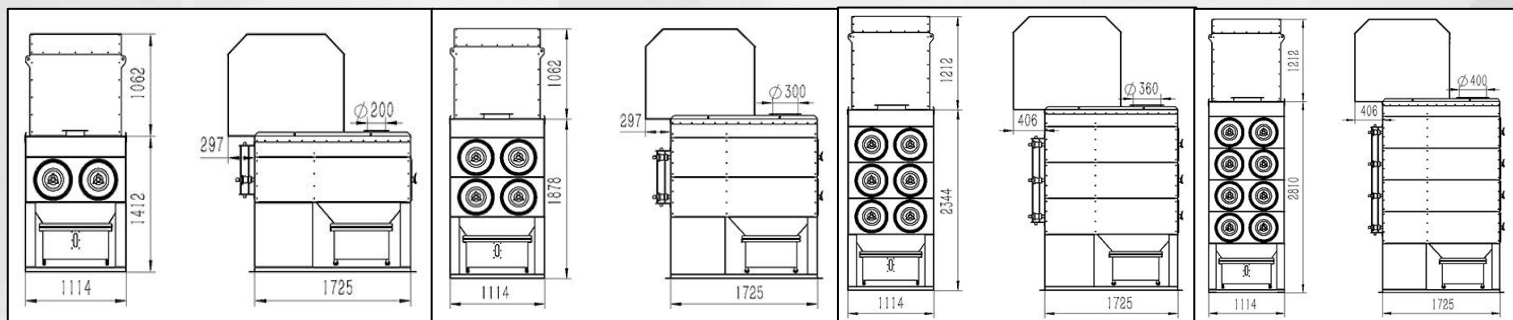

Easy Cartridge Changeout

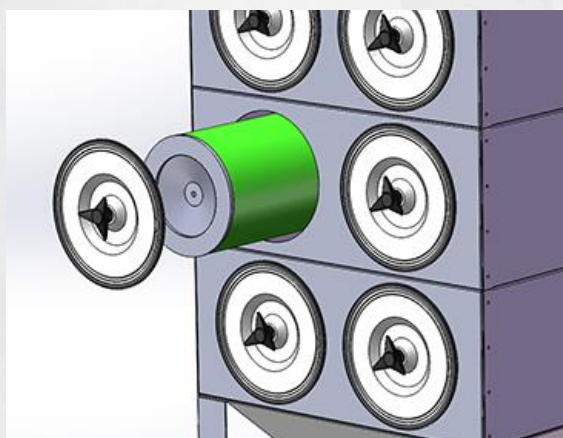

Typical Installation

